

# SOLOS Kids Standing Desk Shelf

## Installation Guide

SD-KStand001-WH

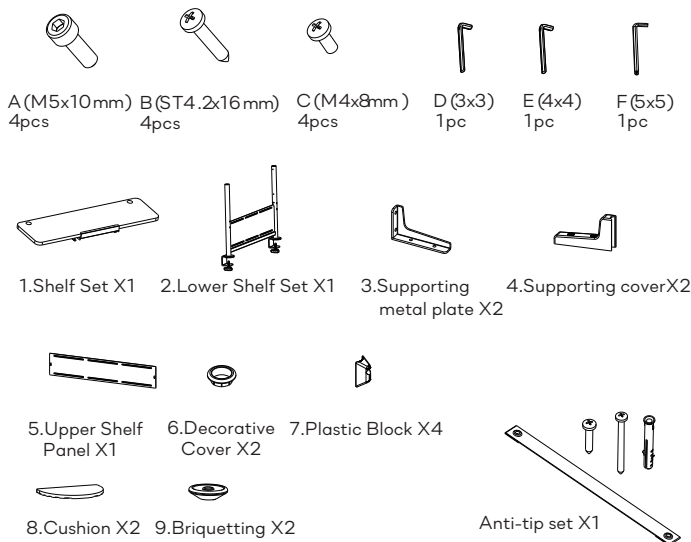
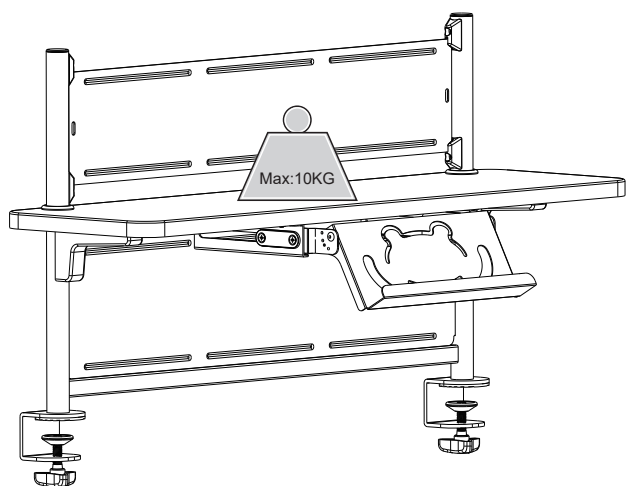

### STEP1

Install the supporting metal plate, shelf panel and Supporting cover

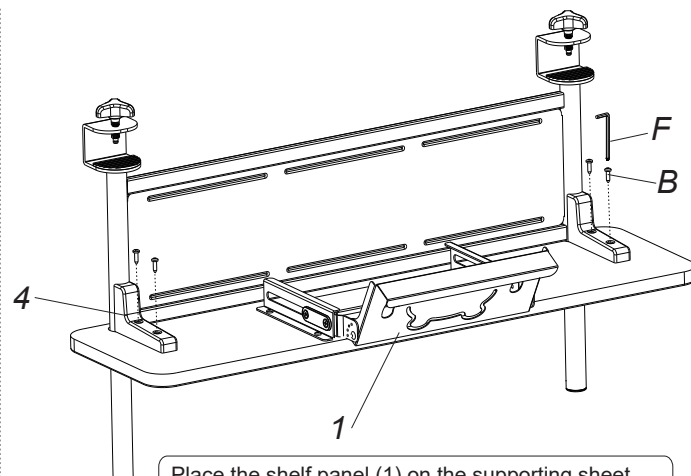
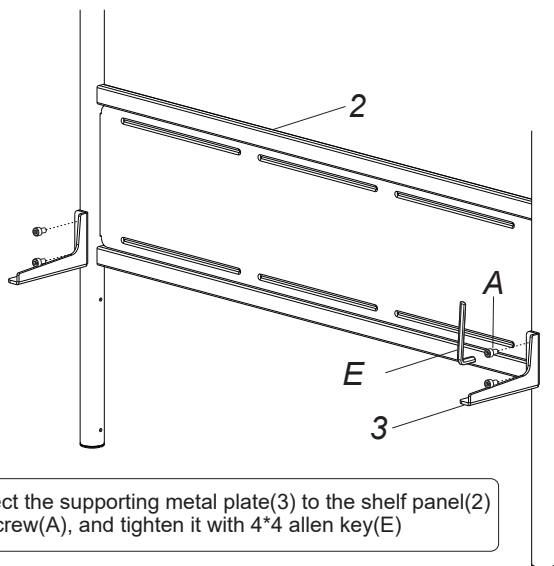
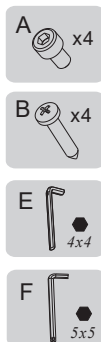

### STEP2

Install the decorative cover

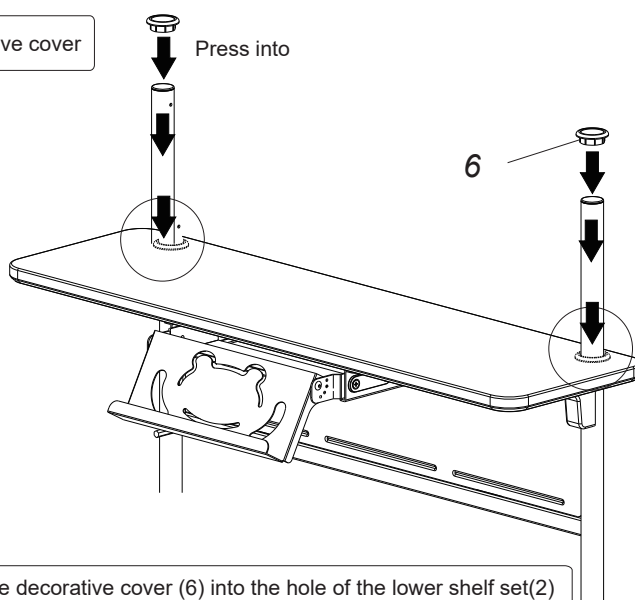

## STEP4

Install the Briquetting and Cushion

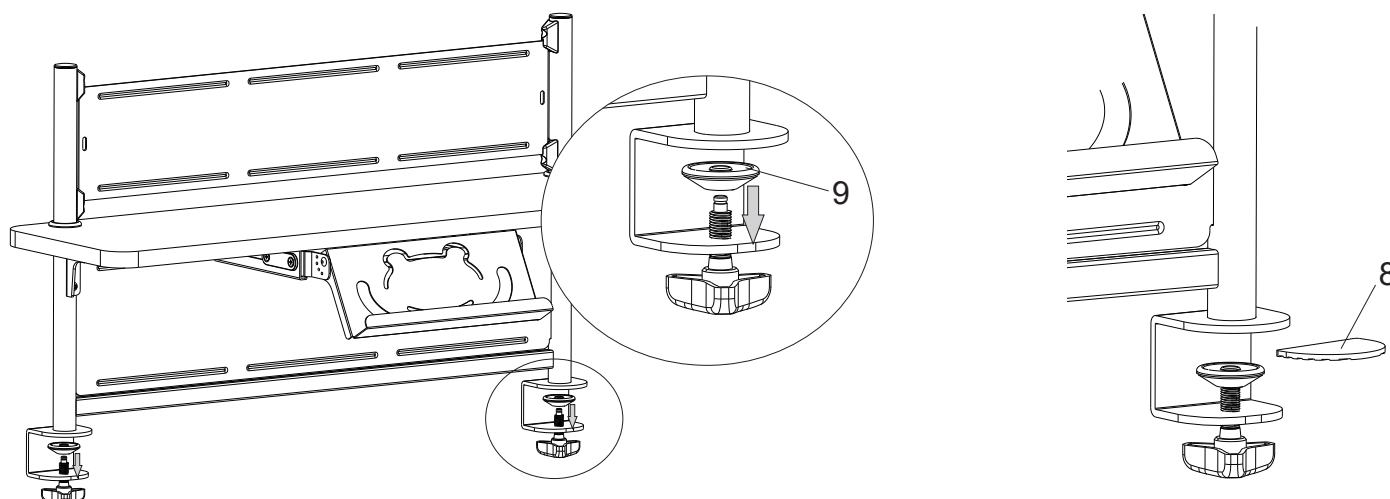

## STEP5

Shelf panel final assembly

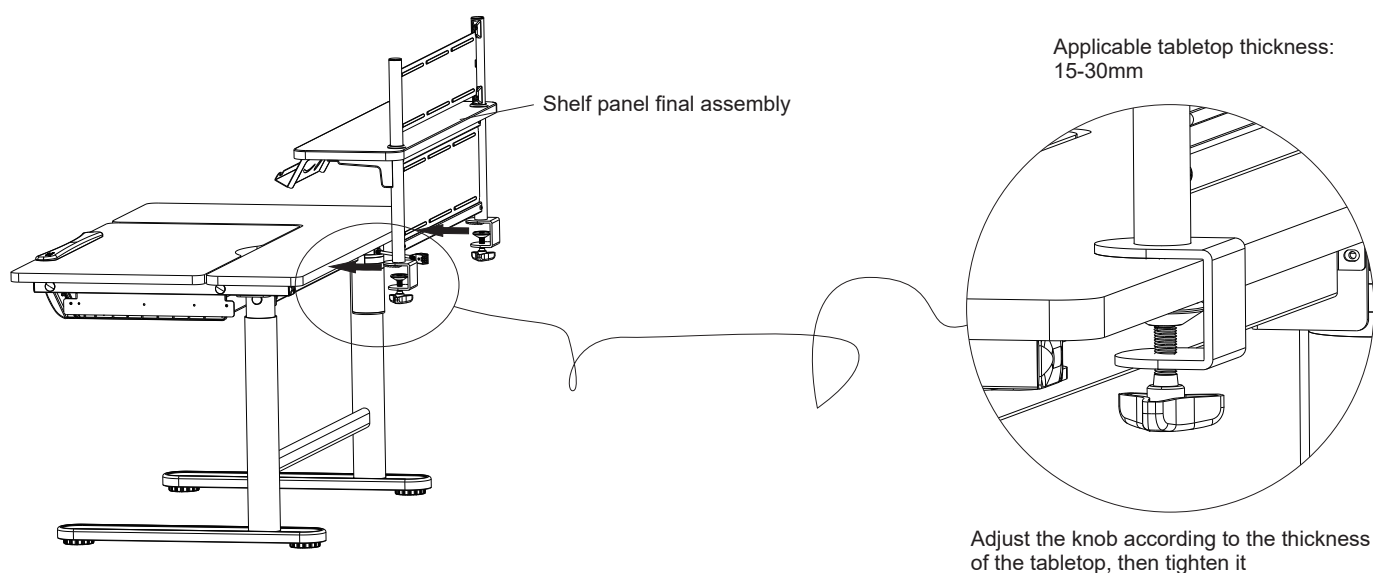

## STEP6

Connect the anti-tip strap to the shelf panel

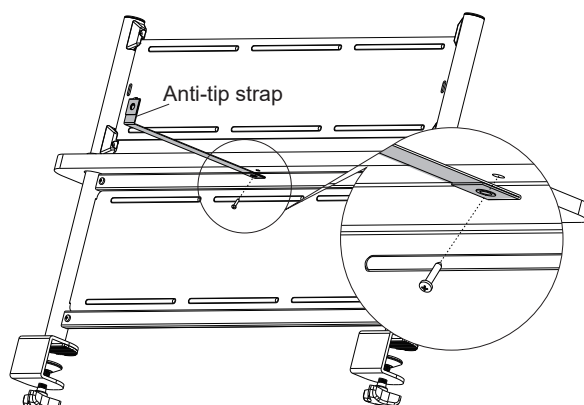

### STEP3

Install the plastic block and upper shelf panel



1

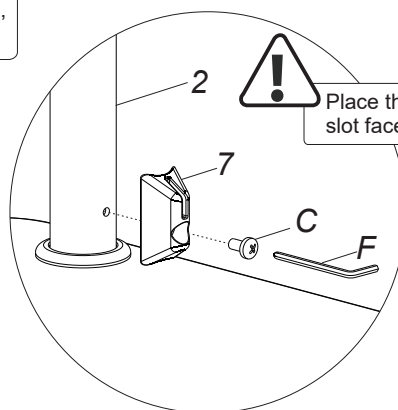
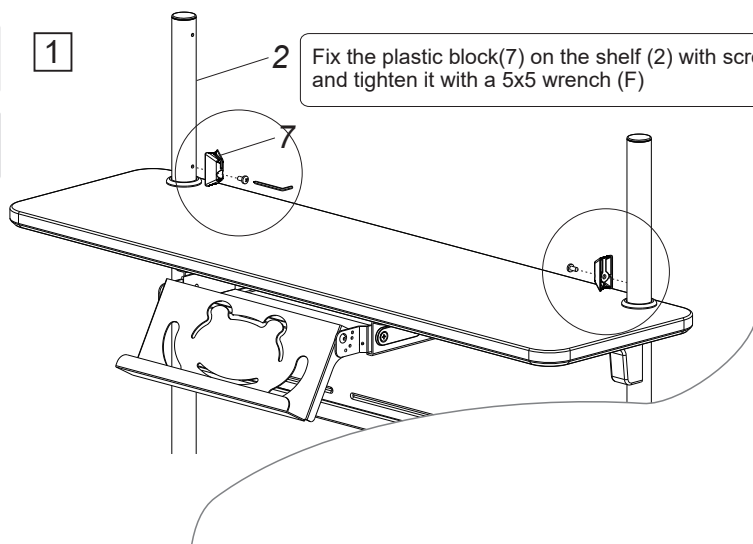

2

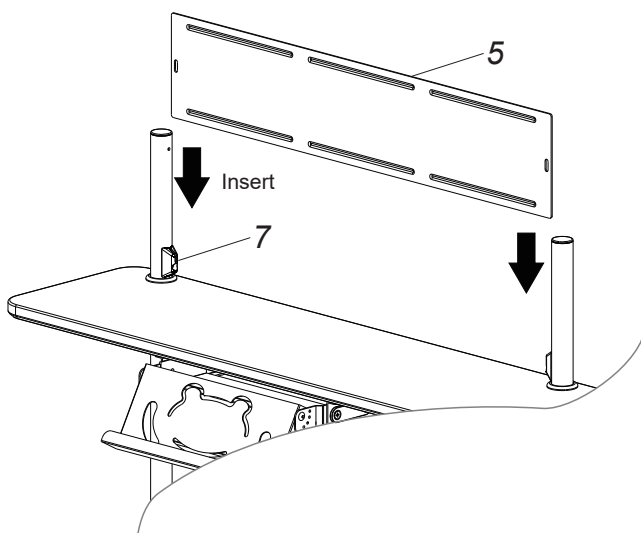

Insert the upper frame (5) into the groove of the plastic block (7)

3

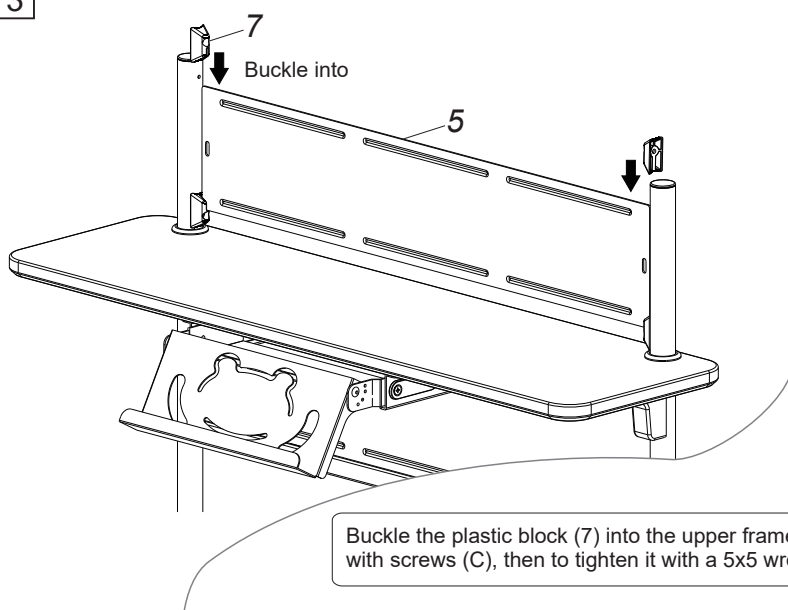

Buckle the plastic block (7) into the upper frame (5) and fix it with screws (C), then to tighten it with a 5x5 wrench (F)

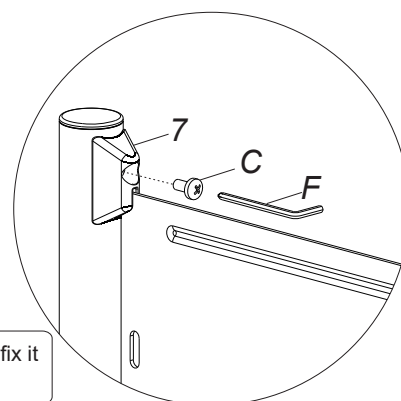

## STEP7

Connect the anti-tip strap to the wall

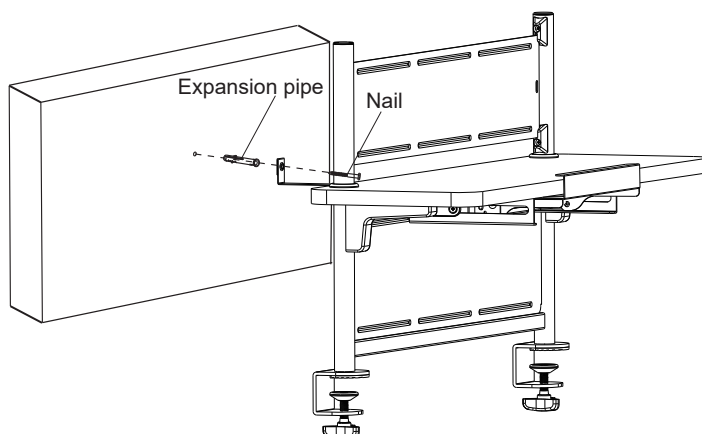
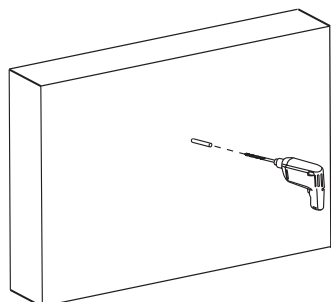
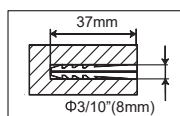

### Reading rack instruction

Load capacity: 0.5kg

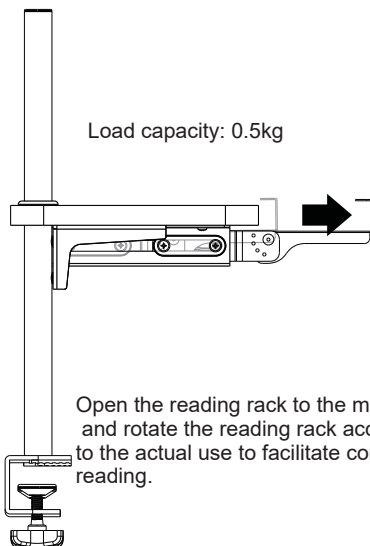

Open the reading rack to the maximum, and rotate the reading rack according to the actual use to facilitate comfortable reading.

According to the actual use, the reading rack can be rotated to facilitate comfortable reading.

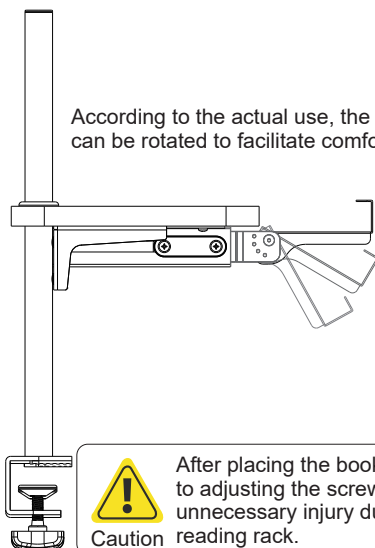

Caution

After placing the book, pay attention to adjusting the screws to avoid unnecessary injury due to loose reading rack.

